

CDD Environmental Meeting Agenda

November 02, 2023

Draft Agenda 11-2-23

1. Call to Order and Roll Call

1. Committee: Chairman Larry Lancette, () Jill Rowan () Harry Davis () Brian Murphy () John Puzine () Bob Daniels ()
1. RCDD Board Liaison: Don Myhrberg. ()
2. Environmental Consultant Hall and Associates Tim Hall ()
3. CDD site Manager John Mercer ()

1. Committee Approvals

1. Meeting minutes 10-05-23

2. New agenda

1. Don Myhrberg: BOS requests

3. Lake/Ponds

1. John Mercer Update
2. Lake Management Reports
3. Status of the fenced pond planting experiment
4. Lake 16 & 17 Water Lettuce update

4. Preserve Management 2023

1. John Mercer update
2. Preserve Status update.
 1. Status of an updated RCDD Exotic Densities Map
3. Management Reports
4. Preserve J2: The October meeting options for the management of exotic removal in J2 i.e., hand cut and removal, kill in place, machine removal from the upland edges, funding over time through doing small areas each year, or tapping reserves were also explored. All options are best done during the dry season.
5. Preserve O2: Apparently, a large area of the preserve was cleared after Charlie (storm cleanup, I presume). Subsequently, the area was planted in lawn, and it has been mowed ever since...
 1. SFWMD Permit Summary for Royal Oaks plus 2004 and 2023 Aerials 3444 Pennyroyal (attached).
6. DM will discuss options with Tim Hall and the RCDD lawyer as this clearing was done around 2004 and only recently discovered.

5. Storm Water Management

1. Additional work along Club Drive proposed by DeClercq Construction. Estimates 05/01/23 below.
 1. Update: DeClercq's work on a 12inch diameter culvert underneath the entrance to Pond #55.
 2. Update: Add new 24' culvert pipe 12", remove pavers, dig trench for culvert pipe, lay culvert in place and backfill with crushed concrete, repour with concrete or lay pavers back in place.
\$4,250.00

6. Common Elements

1. Update: JM suggested investigating stormwater drainage issues at Parcel B- Common Element ID# RR behind tennis courts adjacent to Harbor Lakes. TH will investigate parcel and adjacent area mapping to determine the presence of any property easements.
2. Upstate: Riverwood Drive options for pine replacement will be researched by JR.

7. New Business

1. EDD EC Committee Resignation: Laurie Brogan
2. JM to provide Riverwood Lake and Preserve Identification maps for the new committee members.

8. Old Business

9. Audience -Comments:

10. Next meeting is December 7,

2 Committee Approvals

2.1. Meeting minutes 10-05-23

Riverwood CDD Environmental Committee
Meeting Minutes – October 5, 2023

Members present – B. Murphy, chair; B. Daniels, J. Puzine, J. Rowan (JR)

Also present – RCDD Liaison: D. Myhrberg (DM); RCDD site manager: J. Mercer (JM)

1. The minutes from the 09/07/2023 meeting was approved.
2. **From the Board of Supervisors:** The budget for the fiscal year 2024 has been approved.
3. **Ponds:**
 - a. JM reports that ACI has finished their contract with the RCDD and submitted timely reports. Aquatic Weed Control's regional manager, Joe Vasquez, has visited and toured the campus with JM. JM was impressed with Joe's knowledge of both the campus and the issues affecting the ponds. Pond lettuce in Pond #17 and possibly blue/green algae in 16 will be closely watched.
 - b. Rock behind 14311 Reserve Ct erosion project has been placed.
 - c. The fencing on the pond planting on Pond #12 has been reinstalled, the residents there decided to hold off on adding stone to the shoreline at this time.
 - d. The committee decided that before and after pictures of pond planting projects would be useful in the future for resident education purposes.
4. **Preserves:**
 - a. Options for the management of exotic removal in J2 were discussed, i.e. hand cut and removal, kill in place, machine removal from the upland edges, funding over time through doing small areas each year, or tapping reserves were also explored. All options are best done during the dry season. The issue will be **added to the February agenda** when most committee members will be present.
 - b. Preserve O2 has been cleared by a homeowner and turned into lawn to the bank of the adjacent pond. **DM will discuss** options with Tim Hall and the RCDD lawyer as this clearing was done around 2004 and only recently discovered.
 - c. The committee reviewed the preserve management reports. Tim Hall is due to provide to the committee an updated exotic density map.
5. **Storm Water Management**
 - a. There are two areas that experience slow drainage after heavy rains that may need work. An area around the tennis courts and the egress area of the dog park. JM has suggested a fix that could be completed with heavy equipment that is currently on site. He will schedule this if it seems feasible. The tennis court area fix is more complicated and will need to be explored further for possible work during the dry season.
 - b. The Board approved the recommendation by the committee that DeClercq complete work on a 12inch diameter culvert underneath the entrance to Pond #55. It will be scheduled. **JM will inform the community** of this work by email after it is on the schedule.
6. **Common Elements**
 - a. Some dead pines along Riverwood Drive will be removed due to the safety hazard posed during wind and heavy events. Best options for pine replacement will be **researched by JR.**

3.1 Page 1



AQUATIC WEED CONTROL, Inc.

Orlando - Ft. Myers - Tampa - Daytona Beach 800-543-6694

Lake & Wetland Customer Service Report

Job Name: Lakes
 Customer Number: 875 Customer: RIVERWOOD CDD
 Technician: Ron
 Date: 10/03/2023 Time: 03:45 PM
 Customer Signature: _____

Waterway Treatment	Algae	Submersed Weeds	Grasses and brush	Floating Weeds	Blue Dye	Inspection	Request for Service	Restriction	# of days
4a			X						
4b			X						
5a			X						
5b			X						
6 threw 18			X						
17			X	X					
19 threw 23			X						
3			X						
36			X						
37			X						

CLARITY < 1' 1-2' 2-4' > 4'

FLOW None Slight Visible

METHOD ATV Airboat Backpack Boat Truck

CARP PROGRAM Carp observed Barrier Inspected

WATER LEVEL High Normal Low

WEATHER Clear Cloudy Windy Rainy

FISH and WILDLIFE OBSERVATIONS

Alligator Anhinga Bass Bream

Catfish Cormorant Egrets

Gallinules Gambusia Herons Ibis

Osprey Otter Snakes Turtles

Woodstork

NATIVE WETLAND HABITAT MAINTENANCE

Arrowhead Bulrush Golden Canna Gulf Spikerush Lily

Bacopa Chara Cordgrass

Beneficial Vegetation Notes:

Naiad Pickerelweed Soft Rush



AQUATIC WEED CONTROL, Inc.

Orlando - Ft. Myers - Tampa - Daytona Beach 800-543-6694

Lake & Wetland Customer Service Report

Job Name: Lakes
 Customer Number: 875 Customer: RIVERWOOD CDD
 Technician: Ron
 Date: 10/10/2023 Time: 11:15 AM

Customer Signature: _____

Waterway Treatment	Algae	Submersed Weeds	Grasses and brush	Floating Weeds	Blue Dye	Inspection	Request for Service	Restriction	# of days
24			X						
25			X						
26			X						
29			X						
30			X						
22			X						
34			X						
35			X						
49			X						
50			X						
51			X						
52			X						

CLARITY	FLOW	METHOD	CARP PROGRAM	WATER LEVEL	WEATHER
<input type="checkbox"/> < 1'	<input type="checkbox"/> None	<input checked="" type="checkbox"/> ATV	<input type="checkbox"/> Boat	<input type="checkbox"/> High	<input checked="" type="checkbox"/> Clear
<input type="checkbox"/> 1-2'	<input checked="" type="checkbox"/> Slight	<input type="checkbox"/> Airboat	<input type="checkbox"/> Truck	<input type="checkbox"/> Normal	<input type="checkbox"/> Cloudy
<input checked="" type="checkbox"/> 2-4'	<input type="checkbox"/> Visible	<input type="checkbox"/> Backpack	<input type="checkbox"/> Barrier Inspected	<input type="checkbox"/> Low	<input type="checkbox"/> Windy
<input type="checkbox"/> > 4'					<input type="checkbox"/> Rainy

FISH and WILDLIFE OBSERVATIONS

<input checked="" type="checkbox"/> Alligator	<input type="checkbox"/> Catfish	<input type="checkbox"/> Gallinules	<input type="checkbox"/> Osprey	<input type="checkbox"/> Woodstork
<input type="checkbox"/> Anhinga	<input checked="" type="checkbox"/> Coots	<input checked="" type="checkbox"/> Gambusia	<input type="checkbox"/> Otter	<input type="checkbox"/> _____
<input checked="" type="checkbox"/> Bass	<input type="checkbox"/> Cormorant	<input type="checkbox"/> Herons	<input type="checkbox"/> Snakes	<input type="checkbox"/> _____
<input checked="" type="checkbox"/> Bream	<input type="checkbox"/> Egrets	<input type="checkbox"/> Ibis	<input checked="" type="checkbox"/> Turtles	

NATIVE WETLAND HABITAT MAINTENANCE

<input checked="" type="checkbox"/> Arrowhead	<input checked="" type="checkbox"/> Bulrush	<input checked="" type="checkbox"/> Golden Canna	<input type="checkbox"/> Naiad	<input type="checkbox"/> _____
<input type="checkbox"/> Bacopa	<input type="checkbox"/> Chara	<input checked="" type="checkbox"/> Gulf Spikerush	<input checked="" type="checkbox"/> Pickerelweed	
<input checked="" type="checkbox"/> Blue Flag Iris	<input checked="" type="checkbox"/> Cordgrass	<input type="checkbox"/> Lily	<input type="checkbox"/> Soft Rush	<input type="checkbox"/> _____

Beneficial Vegetation Notes:



AQUATIC WEED CONTROL, Inc.

Orlando - Ft. Myers - Tampa - Daytona Beach 800-543-6694

Lake & Wetland Customer Service Report

Job Name: Lakes
 Customer Number: 875 Customer: RIVERWOOD CDD
 Technician: Ron
 Date: 10/24/2023 Time: 03:00 PM
 Customer Signature: _____

Waterway Treatment	Algae	Submersed Weeds	Grasses and brush	Floating Weeds	Blue Dye	Inspection	Request for Service	Restriction	# of days
11			X						
12			X						
13			X						
4A-4B			X						
24			X						
25			X						
26			X						
29			X						
30			X						
20			X						
21			X						
22			X						
23			X						
34			X						

<u>CLARITY</u>	<u>FLOW</u>	<u>METHOD</u>	<u>CARP PROGRAM</u>	<u>WATER LEVEL</u>	<u>WEATHER</u>
<input type="checkbox"/> < 1'	<input type="checkbox"/> None	<input checked="" type="checkbox"/> ATV	<input type="checkbox"/> Boat	<input type="checkbox"/> High	<input type="checkbox"/> Clear
<input type="checkbox"/> 1-2'	<input checked="" type="checkbox"/> Slight	<input type="checkbox"/> Airboat	<input type="checkbox"/> Truck	<input checked="" type="checkbox"/> Normal	<input type="checkbox"/> Cloudy
<input checked="" type="checkbox"/> 2-4'	<input type="checkbox"/> Visible	<input type="checkbox"/> Backpack	<input type="checkbox"/> Barrier inspected	<input type="checkbox"/> Low	<input checked="" type="checkbox"/> Windy
<input type="checkbox"/> > 4'					<input type="checkbox"/> Rainy

FISH and WILDLIFE OBSERVATIONS

<input checked="" type="checkbox"/> Alligator	<input type="checkbox"/> Catfish	<input type="checkbox"/> Gallinules	<input type="checkbox"/> Osprey	<input type="checkbox"/> Woodstork
<input checked="" type="checkbox"/> Anhinga	<input checked="" type="checkbox"/> Coots	<input checked="" type="checkbox"/> Gambusia	<input type="checkbox"/> Otter	_____
<input checked="" type="checkbox"/> Bass	<input type="checkbox"/> Cormorant	<input checked="" type="checkbox"/> Herons	<input type="checkbox"/> Snakes	_____
<input checked="" type="checkbox"/> Bream	<input checked="" type="checkbox"/> Egrets	<input type="checkbox"/> Ibis	<input checked="" type="checkbox"/> Turtles	

NATIVE WETLAND HABITAT MAINTENANCE

<input checked="" type="checkbox"/> Arrowhead	<input checked="" type="checkbox"/> Bulrush	<input checked="" type="checkbox"/> Golden Canna	<input type="checkbox"/> Naiad	_____
<input checked="" type="checkbox"/> Bacopa	<input checked="" type="checkbox"/> Chara	<input checked="" type="checkbox"/> Gulf Spikerush	<input type="checkbox"/> Pickerelweed	_____
<input checked="" type="checkbox"/> Blue Flag Iris	<input checked="" type="checkbox"/> Cordgrass	<input type="checkbox"/> Lily	<input type="checkbox"/> Soft Rush	_____

Beneficial Vegetation Notes:

5.4.1 Page 1

PERMIT #496845.13 - Riverwood Unit 3 (Grand Vista & Royal Oaks)

1. No owner of property within the subdivision may construct or maintain any building, or residence, or structure, or undertake or perform any activity in the wetlands, buffer areas, and upland conservation areas described in the approved permit and recorded plat of the subdivision.
2. The operations and maintenance entity and owners of lots abutting wet detention ponds shall not remove native vegetation (including cattails) that becomes established in wet detention ponds and wetland mitigation areas. Removal includes dredging, the application of herbicides or algaecides, the introduction of grass carp, and cutting. Maintenance of the ponds shall include keeping structures free of any obstructions.
3. Permanent markers indicating the wetland boundary, or buffer boundary if applicable, will be installed at each lot line radiating from the wetland. A metal plate will be affixed to the marker and will contain the following wording: "Preservation Boundary. No construction or activity downslope from this boundary without prior approval from SWFWMD".
4. The operation and maintenance entity shall submit inspection reports in the form required by the district, in accordance with the following schedule unless specified otherwise herein or in application information. For systems utilizing retention and wet detention, the inspections shall be performed two (2) years after operation is authorized and every two (2) years thereafter.

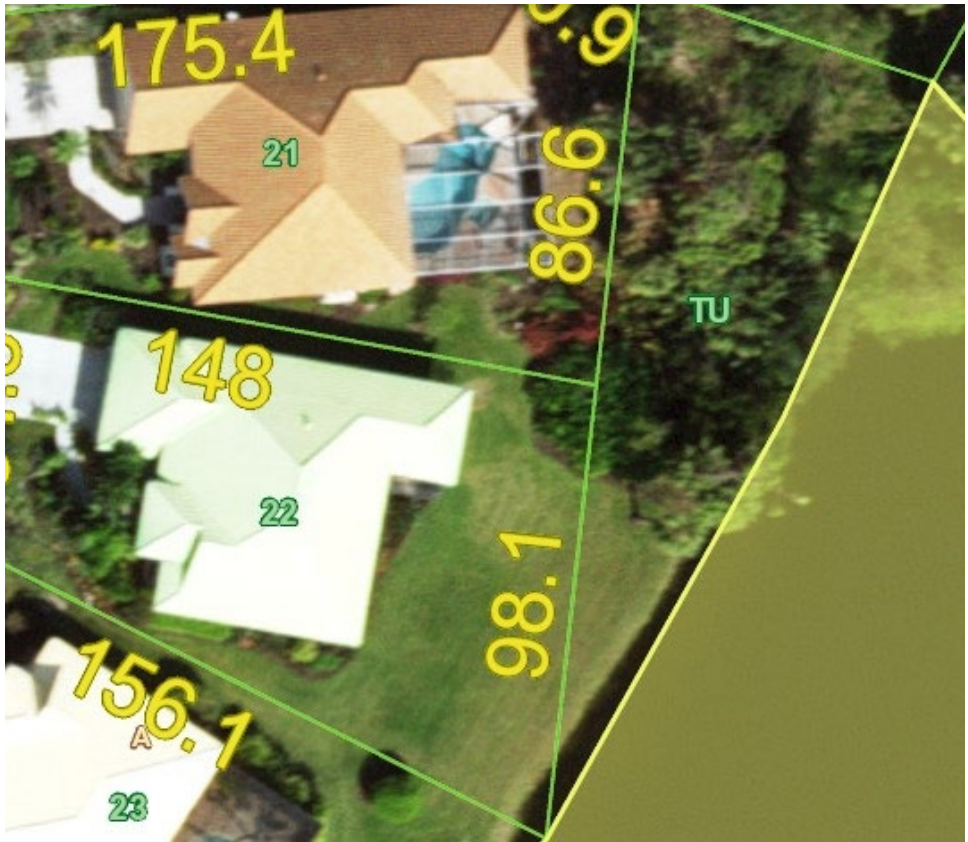

3444 Pennyroyal 2004



08.01

From: Laurie Brogan <mermaid4535@gmail.com>
Subject: Environmental Committee Meeting,
October 5 at 10 a.m.
Date: October 31, 2023, at 7:55:52 AM EDT
To: "Brian D. Murphy" <mbcmurphy81@gmail.com>

Brian I am letting you know that I am, as of today
October 31, resigning from the Environmental
Committee.

I am the primary caregiver for my 84 year old mom and
find I do not have the time needed to contribute
fully and educate myself on the business of the
committee.

Thank you,

Laurie Brogan